

How to Draw a Daffodil

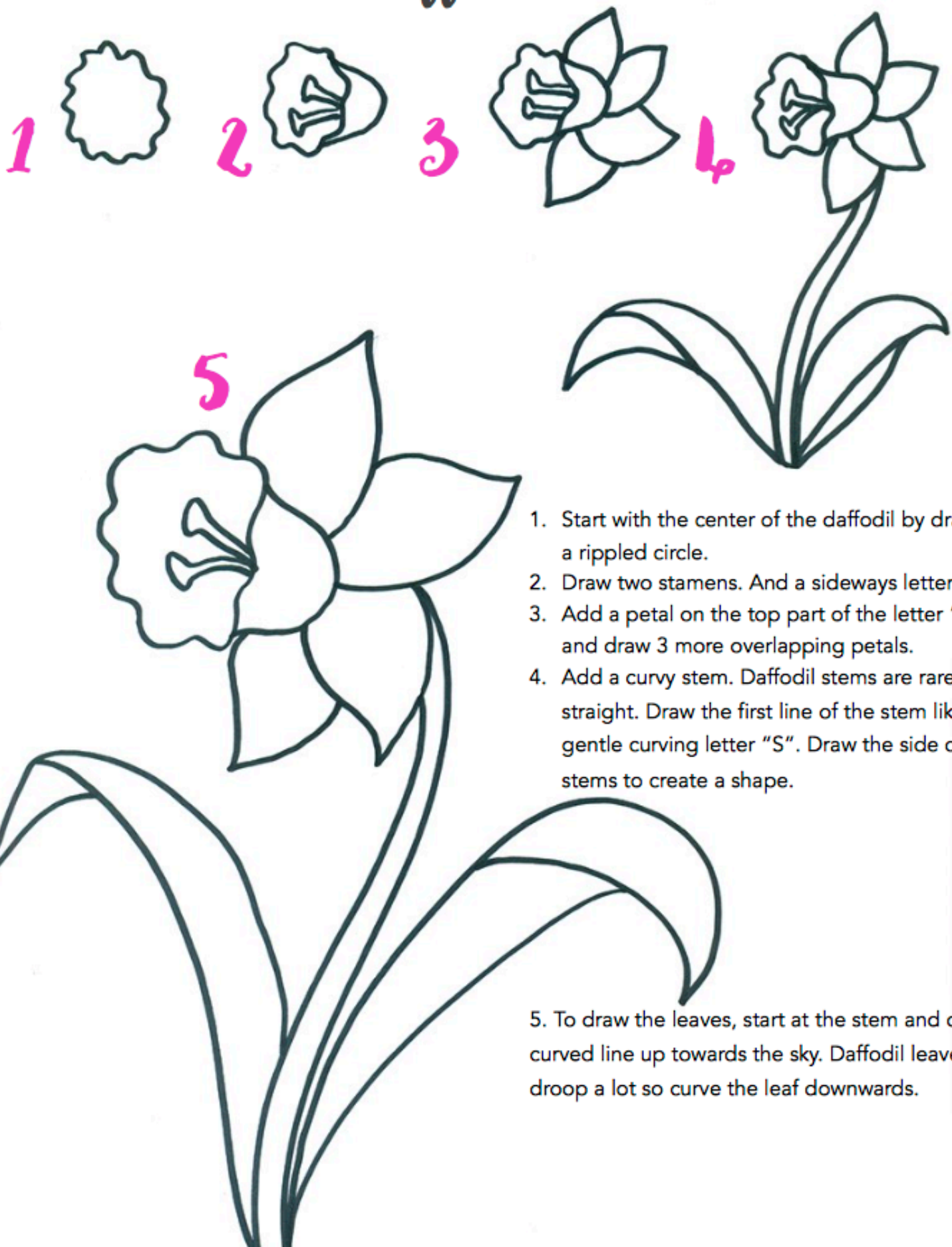

1. Start with the center of the daffodil by drawing a rippled circle.
2. Draw two stamens. And a sideways letter "U".
3. Add a petal on the top part of the letter "U" and draw 3 more overlapping petals.
4. Add a curvy stem. Daffodil stems are rarely straight. Draw the first line of the stem like a gentle curving letter "S". Draw the side of the stems to create a shape.

5. To draw the leaves, start at the stem and draw a curved line up towards the sky. Daffodil leaves droop a lot so curve the leaf downwards.